

RAYEX REC LY4 SERIES

FEATURES

- 4 Pole type are available with switching current of 10A.
- Low coil power consumption with high response time.



ORDERING INFORMATION

LY4 N ——— 12 D S
 1 2 3 4 5

- 1. Type
LY4(4PDT)
- 2. LED
Nil : Without LED
N : With LED
- 3. Coil Nominal Voltage
- 4. Coil Nominal Voltage Type
D : DC
A : AC
- 5. Terminal Type
S : Solder Lug / Plug-In Terminal
P : PCB Terminal

COIL DATA(at 25°C)

| AC 1.8~2.5VA | | | | DC 1.4W~1.5W | | | | |
|--------------------------------|----------------------------|-----------------------------|------------------------------|----------------------------|----------------------------|----------------------|-----------------------------|------------------------------|
| Coil Nominal Voltage (50/60Hz) | Resistance Tol.±10% (Ohms) | Maximum Pick Up Voltage (V) | Minimum Drop Out Voltage (V) | Coil Nominal Voltage (VDC) | Resistance Tol.±10% (Ohms) | Nominal Current (mA) | Maximum Pick Up Voltage (V) | Minimum Drop Out Voltage (V) |
| 12 | 20 | 9.6 | 3.6 | 6 | 25 | 240.0 | 4.8 | 0.6 |
| 24 | 78 | 19.2 | 7.2 | 12 | 100 | 120.0 | 9.6 | 1.2 |
| 48 | 320 | 38.4 | 14.4 | 24 | 350 | 68.6 | 19.2 | 2.4 |
| 110 | 1,600 | 88.0 | 33.0 | 48 | 1,600 | 30.0 | 39.4 | 4.8 |
| 220/240 | 6,700/9,000 | 176/192 | 66/72 | 110 | 6,900 | 15.9 | 88.0 | 11.0 |

RAYEX ELEC.ISSUED RECOY INT'L.

CONTACT RATING

| | | | |
|----------|-----------------------|-------------|-----|
| LY4 TYPE | Resistive (Cos.θ = 1) | AC 250V/28V | 10A |
|----------|-----------------------|-------------|-----|

DIMENSIONS(±0.2mm)

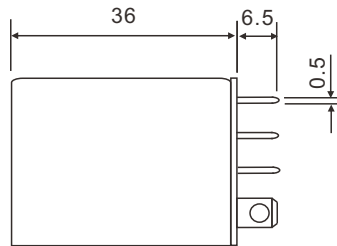
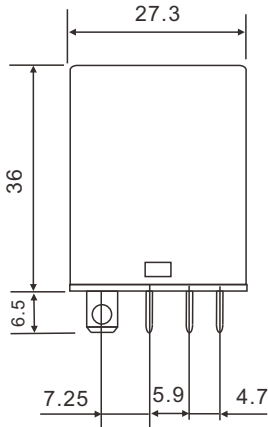

P.C.B LAYOUT (BOTTOM VIEW)

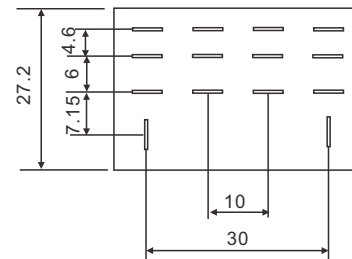

WIRING DIAGRAM (BOTTOM VIEW)

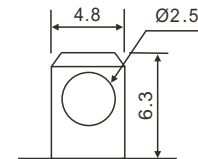
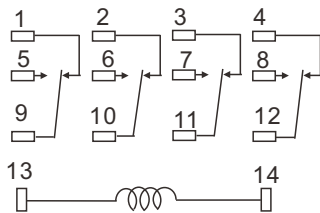

SOLDER LUG/PLUG-INI

GENERAL DATA

| | |
|-----------------------|---|
| Insulation Resistance | 500 MΩ Min. (DC 500V) |
| Dielectric Strength | 1,000 VAC, 50/60Hz between contact. |
| | 1,500 VAC, 50/60Hz between all elements. |
| Contact Material | Ag Alloy. |
| Contact Resistance | 100 milliohms max. (initial value) |
| Shock Resistance | Malfunction: 10G(11ms) ; Destructive: 100G(6ms) |
| Vibration Resistance | Malfunction: 10 to 55 Hz. at Double Amplitude of 1.5 mm |
| | Destructive: 10 to 55 Hz. at Double Amplitude of 1.5 mm |
| Operation Time | 25 ms max. |
| Release Time | 25 ms max. |
| Temperature Range | - 40°C ~ + 55°C |
| Expected Life | With operation rate 30/min. |
| | Mechanical - 10,000,000 operations min. |
| | Electrical - 100,000 operations min. at rated load. |
| Weight | 70 grams |